

**1. USE**

Wireless connected motion sensor.  
 Can control up to 20 wired switches, light micromodules, cable outlets and connected sockets.  
 For indoor and outdoor use.  
 Attaches directly to a wall.

**2. RANGE**

Description	White
Wireless connected motion sensor. Infrared detection 140°, range 8 m. Supplied with 2 AA 1.5 V batteries. With activity and identification LED indicator and RESET button (hidden) used to return to factory settings.	0 648 75 5 742 52

**3. DIMENSIONS (mm)**

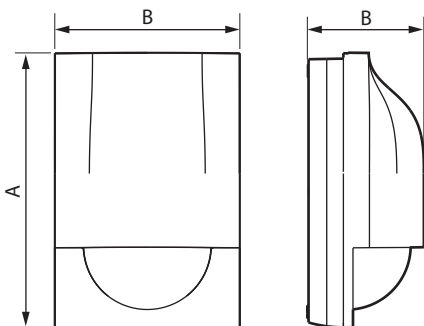

A	B	C
114.5	77	48.5

**4. FUNCTION**

**4.1 Presentation**

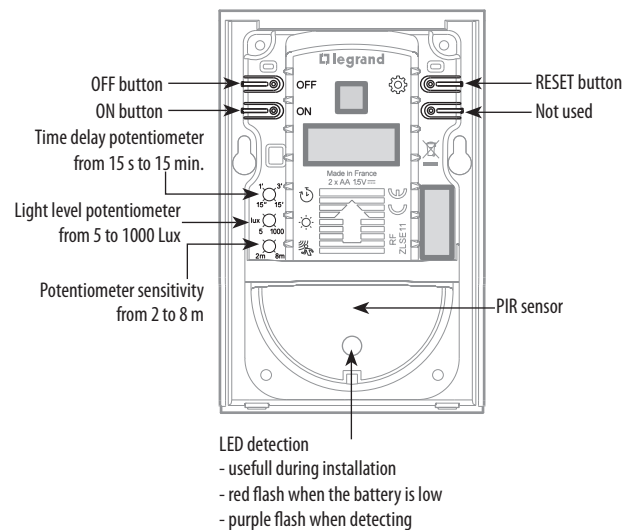

**4.2 Installation**

Optimum distance between 2 sensors: 6 m

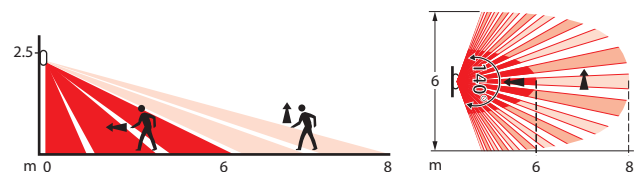
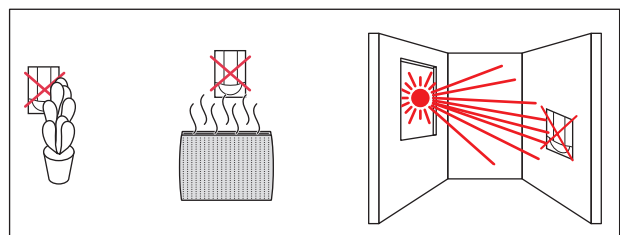

**4.3 Detection**

Minimum installation height: 1 m  
 Ideal installation height: 2.5 m

## 6. TECHNICAL CHARACTERISTICS

### ■ 6.1 Mechanical characteristics

Protection against impacts: IK 04

Protection against solid bodies and liquids: IP 44

### ■ 6.2 Material characteristics

Colour: White RAL 9003

Housing and front cover: PC

Light diffuser: opalescent white plastic shiny aspect with facets

Halogen-free

UV-resistant

### ■ 6.3 Electrical characteristics

Requires 2 AA batteries - 1.5 V

Battery life: 2 years for 50 detections/days and 3 minutes delay.

**Do not use rechargeable batteries.**

Frequency band: 2.4 to 2.4835 Ghz

Power level: < 10 mW

### ■ 6.4 Climate characteristics

Storage temperature: 0°C to + 45°C

Usage temperature: 5°C to + 45°C

## 7. CLEANING

Keep the lens clean.

Surface cleaning with a cloth.

Do not use: acetone, tar remover, trichloroethylene.

Resistance to the following agents: Hexane (EN 60669-1), methylated spirits, soapy water, diluted ammonia, pure bleach diluted to 10%, window-cleaning product, pre-impregnated wipes.

**Caution:** Always test before using other special cleaning products



Battery recycling precaution

## 8. STANDARDS AND APPROVALS

The undersigned, LEGRAND, declares that the radio-electric equipment type (0 648 75 - 5 742 52) complies with directive 2014/53/EU.

The full text of the EU declaration of conformity is available on the following website: [www.legrandoc.com](http://www.legrandoc.com)

Compliant with installation and manufacturing standards.

See e.catalogue.